

I certify that this survey and plan were prepared in accordance with the Procedural and Technical Standards for the Practice of Land Surveying in the Commonwealth of Massachusetts.

I certify that this plan has been prepared in conformity with the rules and regulations of the Registers of Deeds of the Commonwealth of Massachusetts.

I hereby certify that the property lines shown on this plan are the lines dividing existing ownerships, and the lines of the streets and ways shown are those of public or private streets or ways already established, and that no new lines for the division of existing ownership or for new ways are shown.

Date: _____

Professional Land Surveyor

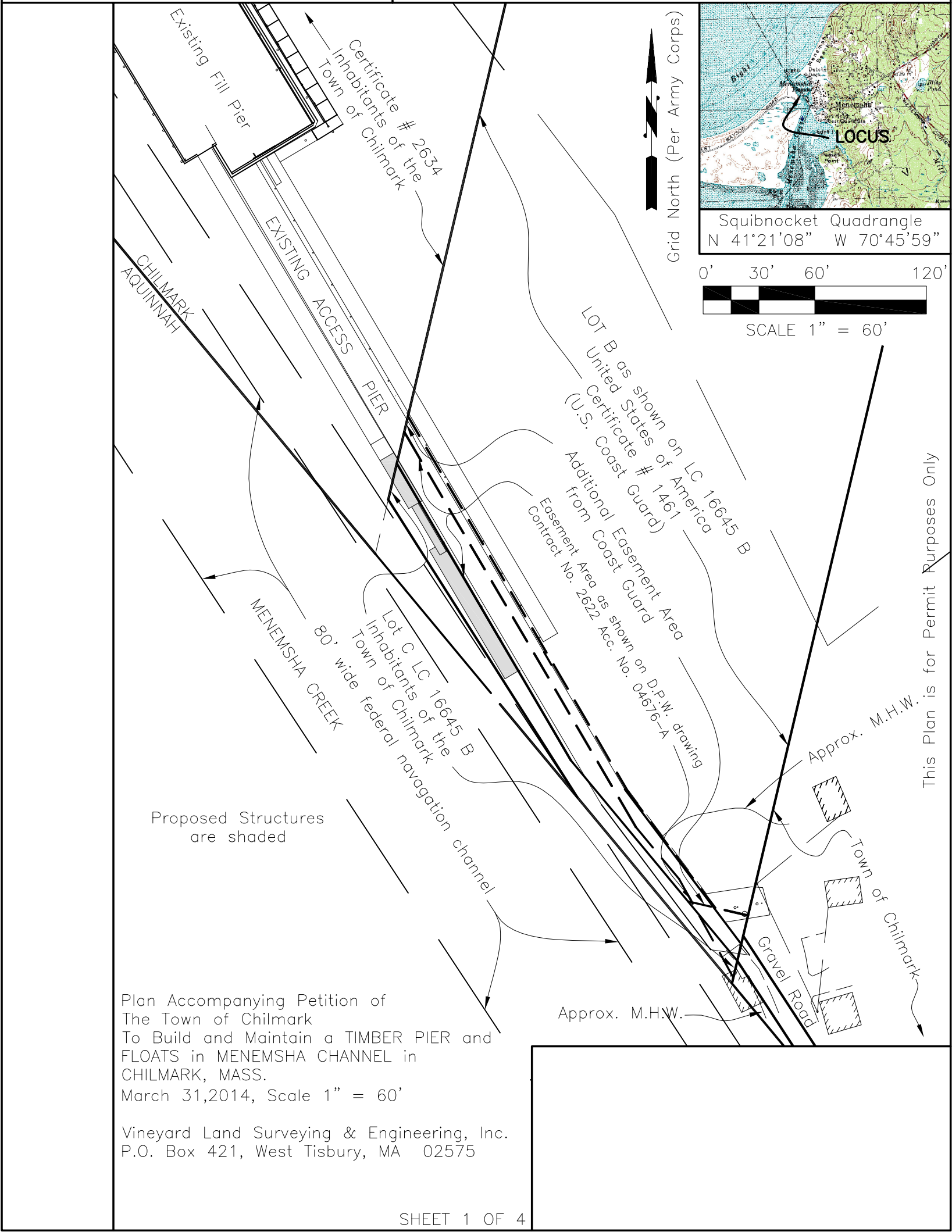

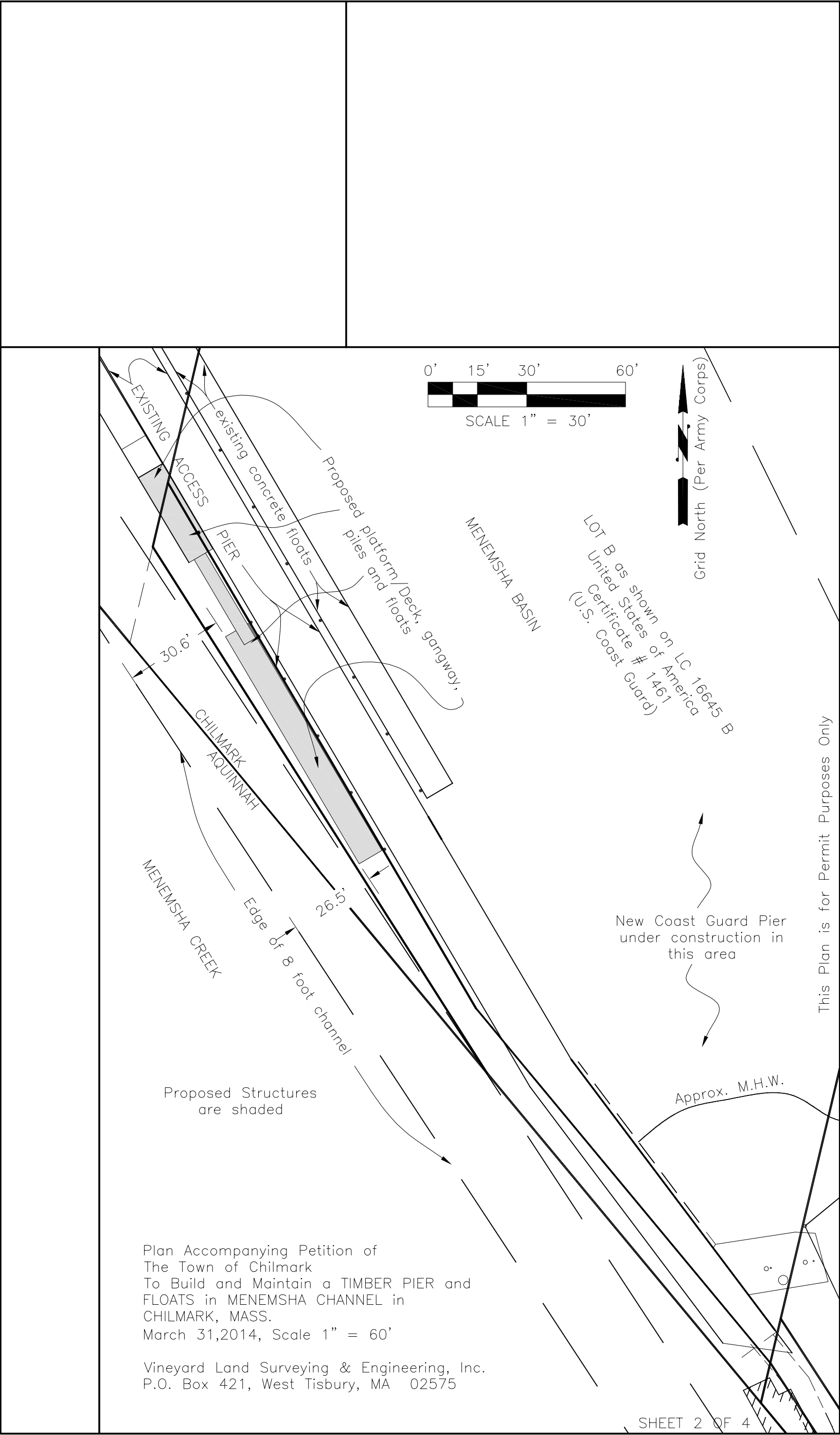

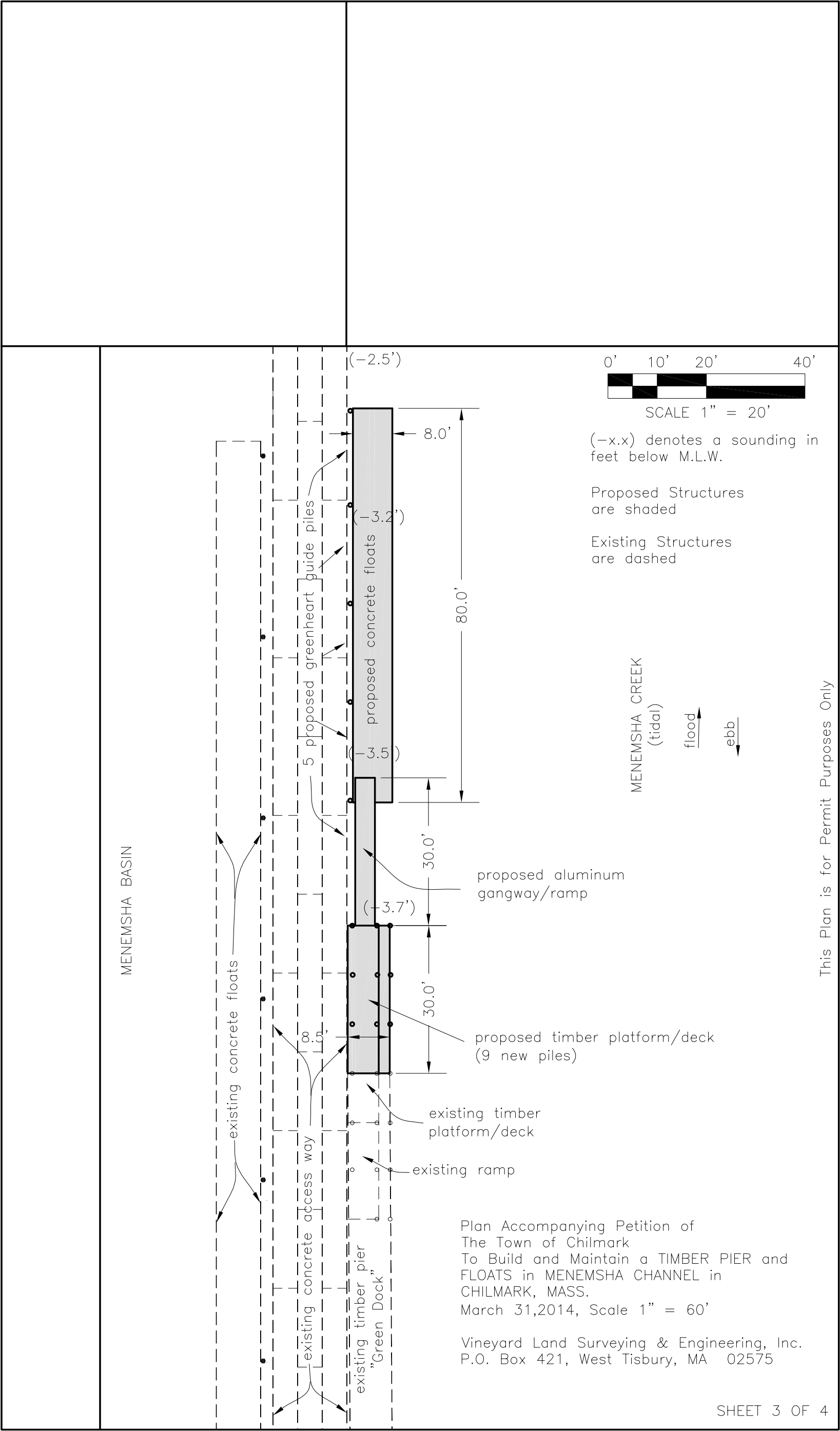

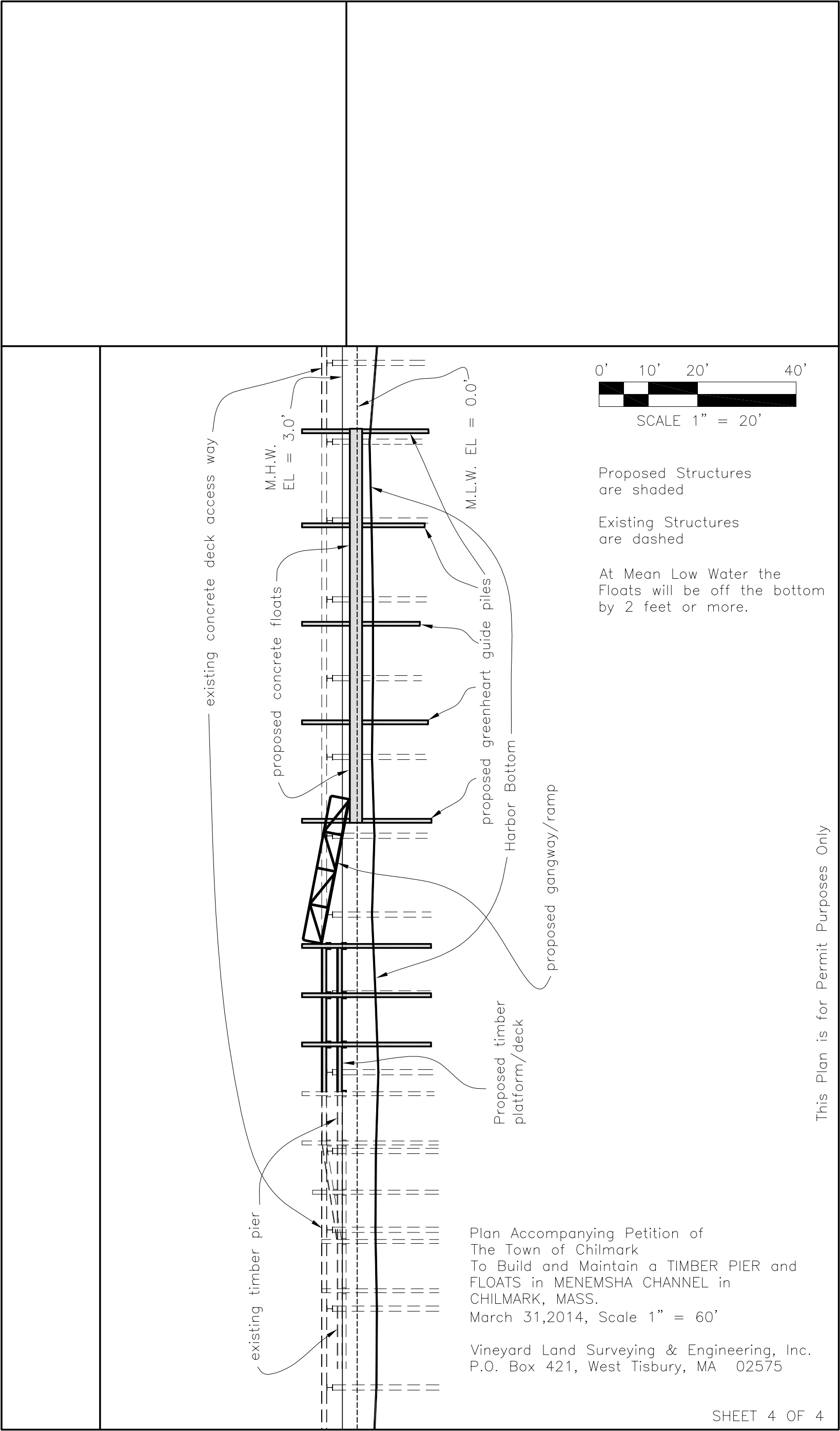

Plan Accompanying Petition of
The Town of Chilmark
To Build and Maintain a TIMBER PIER and
FLOATS in MENEMSHA CHANNEL in
CHILMARK, MASS.
March 31,2014, Scale 1" = 60'

Vineyard Land Surveying & Engineering, Inc.
P.O. Box 421, West Tisbury, MA 02575

This Plan is for Permit Purposes Only